

Virus sampling tubes with swab and UTM

Premium



Description	Premium quality sampling kit with Universal Transport Medium (UTM) for the collection, storage and transportation of human nasopharyngeal or oropharyngeal virus samples. The kit is composed of tube, swab and preservation medium.		
Swab	1 nasopharyngeal swab Tip: Nylon 150 mm Stick: ABS	or	1 oropharyngeal swab Tip: Nylon 150 mm Stick: ABS
Tube	Leak-proof tube body and cap Size: 16 × 100 mm		
Preservation Medium	<p>Non-inactivated Appearance: Clear pink fluid Volume: 3.5 ml or customized volume</p> <p>Solution Based on Hanks' Balanced Salt Solution (HBSS) Sodium chloride: 0.8%, potassium chloride: 0.04%, calcium chloride: 0.014%, magnesium sulfate heptahydrate: 0.02%, disodium hydrogen phosphate heptahydrate: 0.012%, potassium dihydrogen phosphate: 0.006%, sodium bicarbonate: 0.035%, glucose: 0.1%, phenol red sodium salt: 0.002%.</p> <p>Inactivated medium available on request.</p>		
Glass beads	Elution glass bead; Ø 3 mm ± 0.8 mm		
Quantity	20 units/box, 400 units/carton		
Product preservation	Storage: 5–25 °C (41–77 °F) Expiration date: 12 months Please refer to outer box for production and expiration date.		

Sample Requirements	The collected samples should be transported at 2–8 °C (35.6–46.4 °F) and submitted to the laboratory within 48 h.
Re-sampling	If the sampling solution turns yellow or turbid, discard the sample and collect a new sample with a new test kit.
Limitations	Contamination during the sampling process will affect the final results. Sample storage at inappropriate temperatures will affect the final results.

How to use

1.

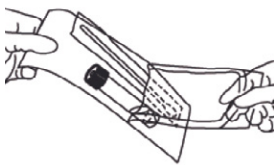

Open kit pack.

2.

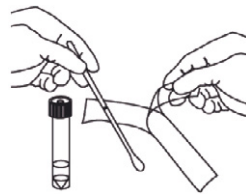

Open swab pack.

3.



Nose swab:

Insert swab in nostril and back to nasopharynx. Leave in place for a few seconds. Slowly withdraw with rotating motion.



Throat swab:

Ask patient to open mouth. Wipe tonsils and back of the throat thoroughly for a few seconds.

4.

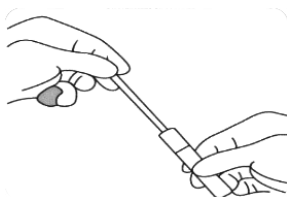

Insert swab into sampling tube.

5.

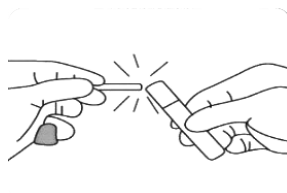

Break shaft slowly at the pre-scored line.

6.

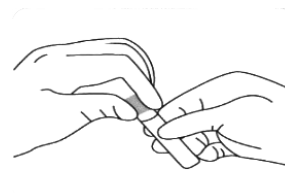

Tighten screw cap and shake. Label tube with appropriate patient information and submit to laboratory.

To place an order, please get in touch via email: sampling@inveox.com

Due to high demand and the need to integrate and optimize various supply chains, the delivered product may vary in appearance and packaging from the item in this description.

inveox GmbH • Lichtenbergstraße 8, 85748 Munich, Germany

www.inveox.com • Telephone: +49 (0) 89 / 57 84 76 01 • Fax: +49 (0) 89 / 41 41 60 543